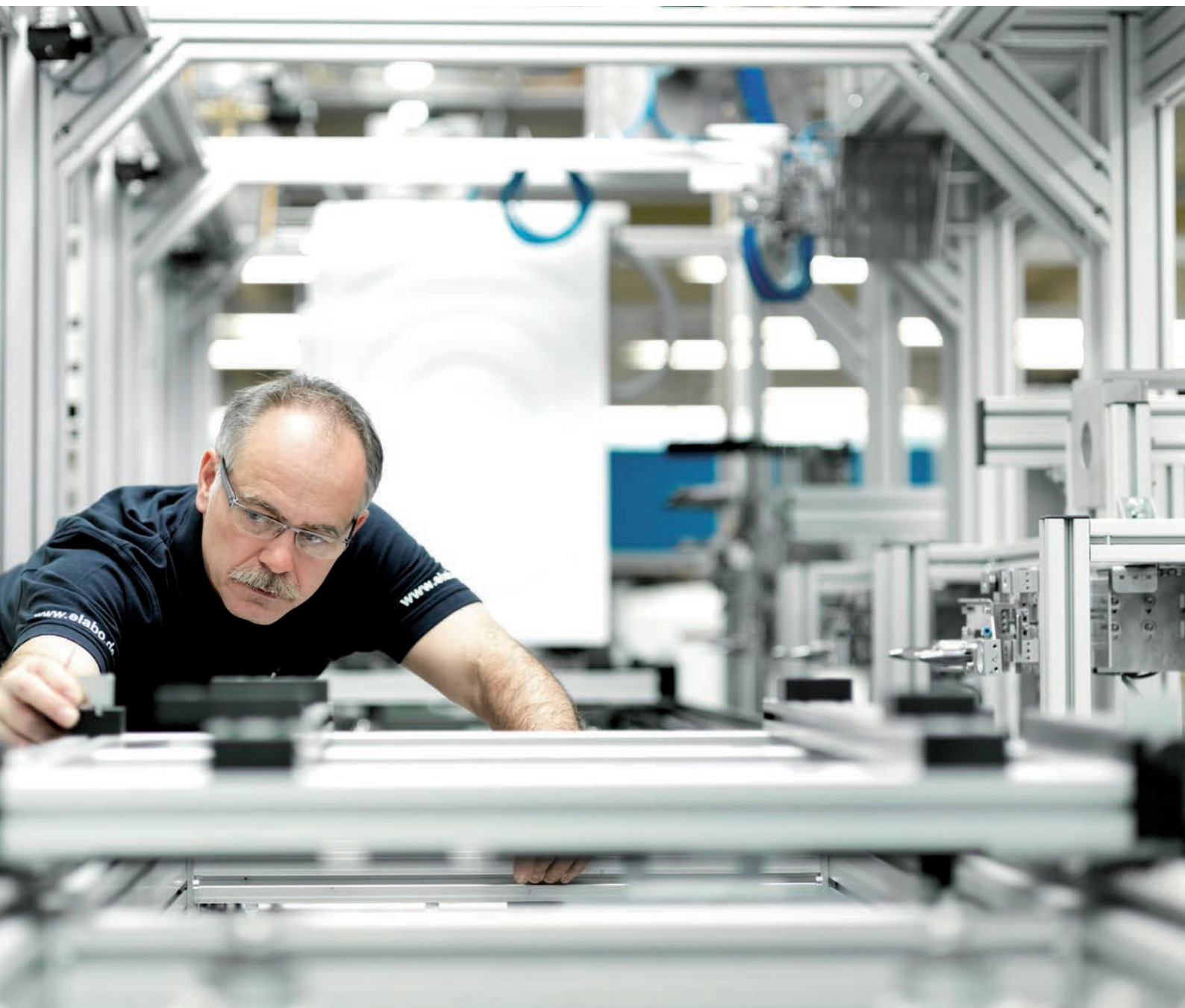



Image Brochure





“If people want to get things done,
they need room for their ideas.”

ELABO is the engine of innovation in the electrical engineering industry.

We are the technology leader in developing and manufacturing intelligent measurement and test equipment for the electrical industry. Customers employ our high-quality devices, software, test systems and furniture for training, research and development, production and quality assurance, as well as customer service.

ELABO holds all its products to the highest standards.

Our team of 180 employees and more than 46 years of hardware and software expertise in development, assembly and distribution continuously ensure innovative solutions.



ELABO is a global player.

We offer a comprehensive distribution and service network covering all of Germany. Our subsidiaries and partners are established in almost every country in Europe. ELABO is active in the Middle East and Asia, in North Africa and North America. Our customers include small and medium-sized enterprises, universities, major German corporations and international companies.

ELABO offers more.

Our demanding customers expect more than just well thought-out system solutions. ELABO therefore offers extensive additional solutions for the complete product portfolio. We accompany our customers from the very beginning, for as long and as intensively as you, the customer, require. We call this ELABO Customer Care.

Workstation Systems



“ELABO doesn't just have answers to your questions, but excellent solutions.”

ELABO designs, develops, and manufactures workstation systems for electrical laboratories, professional training, assembly, and process control stations.

The company sets benchmarks for technical workstation systems in the electronic and electrical engineering sectors that stand for high functionality through intelligent solutions. The systems provide the highest possible quality with remarkable durability and particular cost-effectiveness.

Your advantages

- Technology from the innovation leader
- Four decades of ELABO knowledge gained from practical experience
- Technical aesthetics and modern design
- Cutting-edge ergonomics
- Unbeatable cost-effectiveness
- Intelligent integration of systems
- Maximum spatial efficiency
- One-stop shopping with efficient hardware and software packages
- Robust and durable systems

Testsystems



“If you spend your days carrying out thorough tests for others, you don't compromise when testing yourself.”

ELABO is an international leader in the development and manufacture of systems for testing electrical devices and electrical components and sub-assemblies.

Our measurement and testing devices are used for safety, quality, and function testing in electrical laboratories as well as in mass production. We also provide automated testing systems as individual workstations or as complex testing networks, for a wide range of industries and products.

Your advantages

- For more than 40 years we have been a respected partner for our industrial clients as well as for testing and certification bodies
- Many potential applications (research, development, production)
- Defect prevention and quality assurance by ELABO, for both manual and partially automated production (testing stations integrated into the production process)
- Modularized individual devices and complete systems
- Hardware, software, and components from a single source
- Optimal results through comprehensive know-how in the areas of mechanical engineering, electronics, and programming

Digitization and Industry 4.0

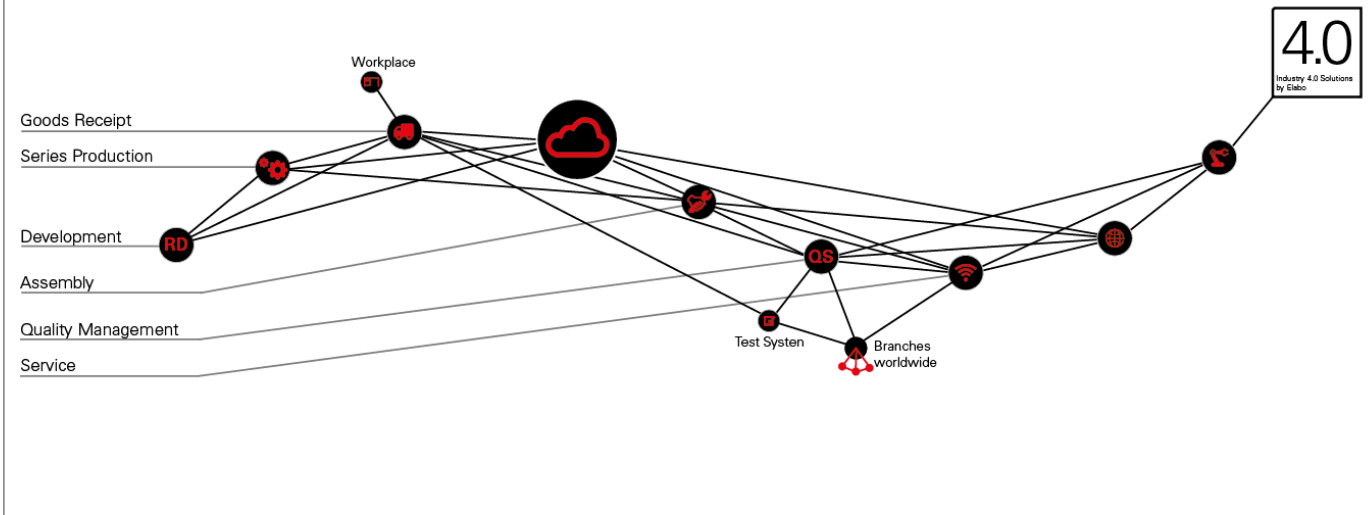

“Producing 100% of quality at the first attempt and stress-free – no problem with ELABO’s software solution”

We are the right partner for addressing digital transformation with you.

Economical challenges, increasingly complex tasks and ever shorter product life cycles are the drivers for people, along with companies, to continuously evolve and adjust. This is why we have been developing smart future-ready solutions for years – solutions that are optimised to today’s requirements and also to tomorrow’s workplaces.

Our promise for your production: Regardless of the employee’s qualification level, complex workflows can be performed

- stress-free, at the first attempt,
- anywhere in the world and
- 100% regulation- and quality-compliant.

ELABO offers its customers a next-generation software.

Elution® software makes it possible to control and operate devices without any programming know-how, to code measuring routines and to analyse measurement and testing results. In addition, the software stands out because it can be used in many different fields of application. Whether in research and development or final testing, or professional training for monitoring and controlling complete classrooms.

Software for

- workplace and work step handling,
- controlling measurement and testing equipment and
- automation technology and quality assurance for
- safety and function.

Service



“Customer Care – far more than assistance”

Tailor-made by the manufacturer.

Standstill and downtime – two words no manufacturing company will accept. The operating personnel may not always detect the cause of failure at first glance, in particular in case of complex systems.

Trained specialists will provide you with customer care through our support hotline. We will analyse your causes of failure via remote maintenance and offer solutions.

If required, even 24/7.

Our in-house service employees can be at your side in no time. If you opt for our service and maintenance agreement, you will be able to contact us even outside of regular business hours, depending on your chosen service level. Our on-call service for you reduces your own resource requirements. And if worse comes to worst, we will be at your premises as quickly as possible.

Your benefits.

A system may be as high quality as it may – time will take its toll. Unfortunately, every system is subject to wear and tear, even ELABO's quality products. Preventive maintenance and periodic calibration help to avoid damage at a later stage and extend the system's useful life.

Augmented Reality

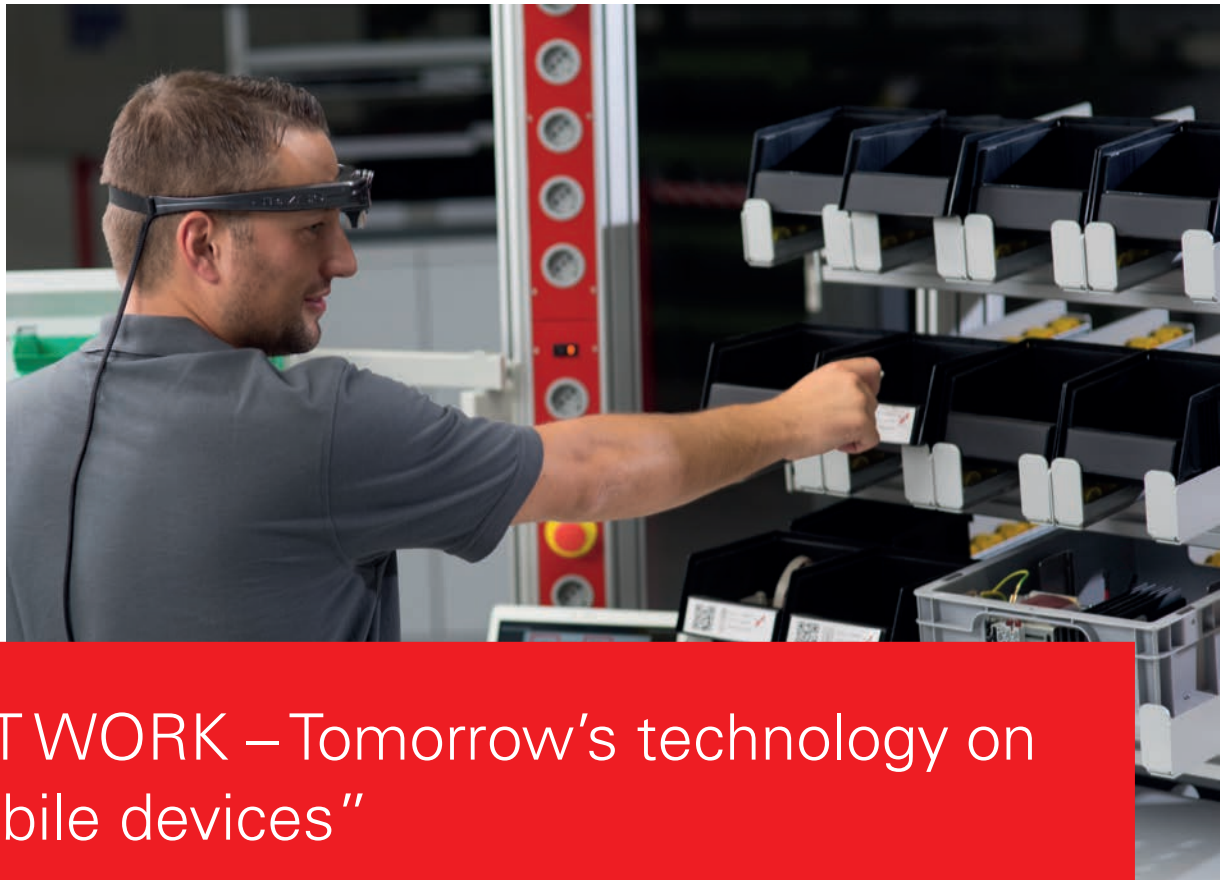

“SMART WORK – Tomorrow’s technology on your mobile devices”

Companies must evolve continuously to remain competitive.



The superior discipline here is to harness and establish new business models.

This is why ELABO has evolved from a pure product supplier to a process provider. Smart software solutions – also used on the latest technologies such as Augmented Reality (AR) or platform-agnostic end devices – were a significant contribution.

In a dedicated learning factory, these technologies are given to customers and employees to „play with“.

Virtual Reality

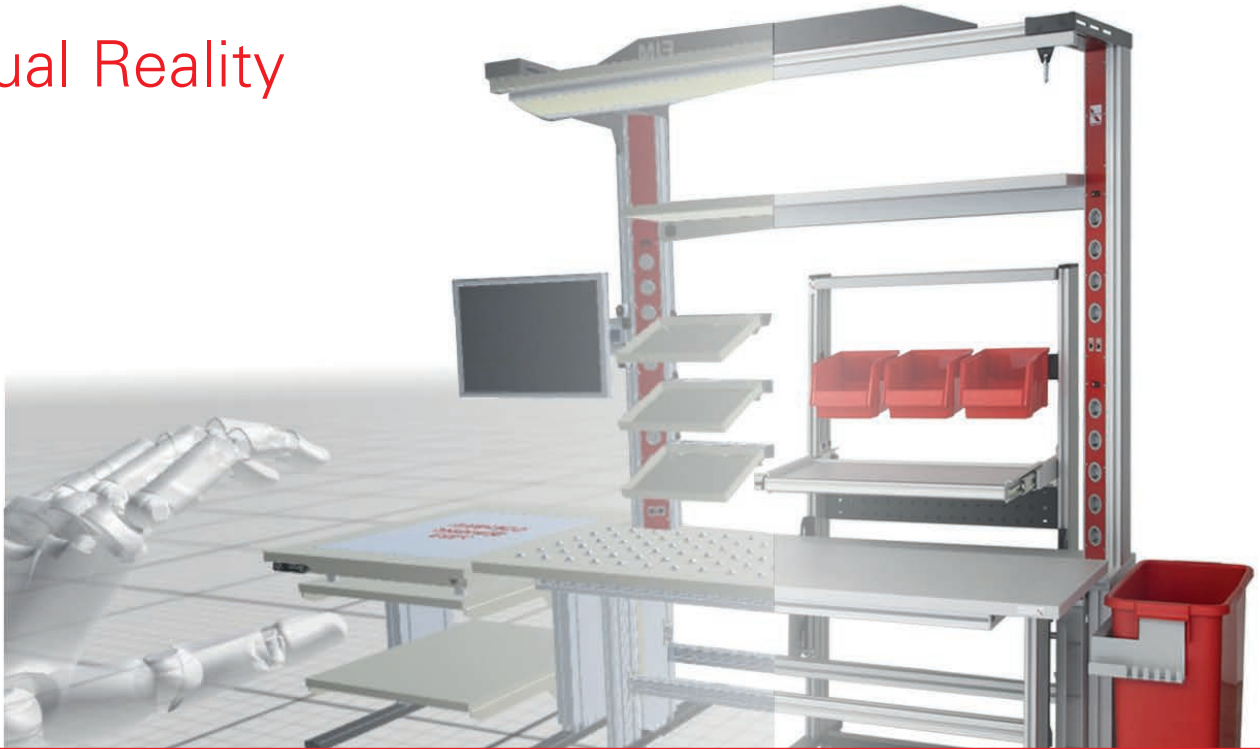

“Virtual Reality – We are creating your new world”

Just like test-driving a new car before buying it, ELABO has turned experiencing a new workplace or testing system into a virtual reality.



Our new VR Center allows customers to put their new equipment to the acid test.

Coupling them to CAD systems makes it possible to quickly implement and virtually test required adjustments.

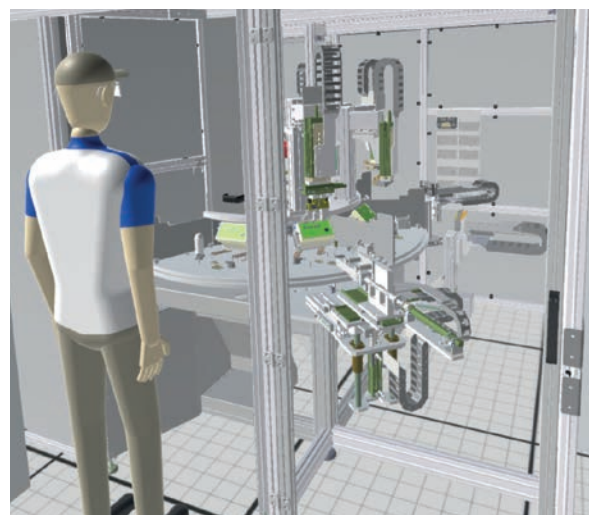

ELABO's milestones.

1980

1980

ELABO launches their first in-house developed safety testing devices.

1982

ELABO brings to market one of the first microcomputer-based safety testing systems.

1985

1988

With the new InForm program line, ELABO kicks off a revolution in the equipment of technical workstations. Electrical supplies, measurement, and testing devices are now located at eye level – with patented connection technology.

1990

1996

ELABO introduces completely networked testing lines for quality assurance in electrical devices.

1995

2000

2000

For the first time, ELABO uses robot and image processing technology in test systems.

These customers trust us.

Industrial firms ABB ABM Greiffenberger Acer ACI Advanced Energy AEG Alfing Alcatel Airbus Alcan Allied Vision Alstom Amica Amphenol Arcelik ASIC ASS Atlas Copco Atmel Audi Aventis B Braun Bachmann Bahn Baker Hughes Ballard BASF Bauknecht Baumüller Bayer Bender Berchtold Berger Bertrandt BERU Bizerba Blaupunkt BMT BMW Boehringer Borg Warner Bosch Bosch Rexroth Bosch Siemens Hausgeräte Braun Brauerei Becks Brose Bruker Bühler Bürkert BVS Canon Captron CareFusion Caterpillar CEAG Cegelec Cherry Clarion Clondiag ContinentalTexes Conwotherm Cooper Daimler Dahle Danfoss Degussa DEKRA Deutsche Bahn Deutsche Post DSK Deutsche Steinkohle DHL Diehl DLR Dräger Dr. Suwelack DSPECIALISTS Durag Dürr EADS E.G.O. ebm-papst Edag e.dis Eisenmann Electrolux Emerson Endress + Hauser E.ON EnBW Enercon Epos Ersol E-T-A Eulenbach ETO-Magnetic Eurocopter FAG Kugelfischer Fanuc Federal-Mogul Fein Feller Fiat Iveco Ford Franke Freudenberg Fronius Gardena Gasag Gedore General Electric Getrag Hansaton Glen Dimplex Göpel Grammer Hahn Harman Becker Harting HBM Hottinger Baldwin Heidenhain Heinzmann Hekatron Helios Hella Hemstedt Hensoldt hps Hilti Hirschmann Hitachi Heraeus Hüner Hüttenwerke Krupp-Mannesmann Hüttinger IBM Igarashi Imperial Imtech INA-Schaeffler Infineon Innovent Inovon Ismet Ivoclar JenCam Jenoptik John Deere Julabo JUMO Johnson Kabel Deutschland KACO Kärcher Kathrein Kemmler & Riehle Knick Knipex Knorr-Bremse Komax Kontron Krauss-Maffei Kronos KUKA Kummer Lear Automotive Leoni Leica Lenze Liebherr Linde LG Loewe Opta LPKF Lumberg Lufthansa LuK Magnet Schultz Mahr MAN Mann + Hummel Marconi Marquardt Mazet MD electronic Medion Melitta Mennekes Mettler-Toledo Metz Merten MF Instruments Micronas Miele Minimax Mitsubishi Molex MTU Aero Engines Neff Nokia Norgren NXP Opel Olympus OMV Osram Otis Panasonic PAS Peiker Petra Pepperl + Fuchs Philips Phoenix Pierburg PGT PMB-Elektronik Porsche Preh Pretti Procter & Gamble Putzmeister Regiulux Rehau Rheinmetall Rhode & Schwarz Riedel Rieter Roche Rodri Rohwedder Röhm Saar Ferngas Sagem Samson Sartorius Schaerer Schaffner Schenck Schering Schleuniger Schneider Schott Schroff Schubert Sennheiser Severin SEW-Eurodrive Sick Siemens Sitec Shell SIM Singulus Sirona Sitec Aerospace SKF SMA Solibro Somfy Stahl Starke STEAG Steiff Stiebel Eltron Stihl Südzucker Suspa Taminco Tehibo Teamtechnik Technisat Teka Teldix Tenovis Texas Instruments Thermokon ThyssenKrupp Ticona Tralec Trilux TRW Tyco UPS Vacuumschmelze Vaillant Valeo Varta Vattenfall Videor Viessmann Visatec Vishay Visteon Vogt Electronic Volvo Vossloh Voith Volkswagen WAGO Waldner Waldmann Weishaupt Wiedemann Wieland WIKAI Witte Wittenstein Wolf WMF Wuekro Würth Yokogawa Zander Zeiss ZF Ziehl-Abegg Zollner

Government agencies, institutions, and service providers
 Thuringian Riot Police Federal Institute for Materials Testing Federal Office for Information Technology Security Federal Office for Protection of the Constitution Federal Office for Defense Technology Federal Ministry of Defense Federal Ministry of Transportation Federal Office of Criminal Investigation Federal Network Agency Federal Police Federal Office for Telecommunications Statistics Deutsche Bahn Deutsche Bundesbank German Weather Service German Aerospace Center Fire departments e.g. in Nuremberg, Hamburg, Düsseldorf, Dortmund Airports e.g. in Berlin, Hannover, Munich, Nuremberg and Frankfurt-Hahn German Red Cross Rescue Service Research centers e.g. in Jülich and Karlsruhe Fraunhofer Institutes e.g. in Berlin, Bremen, Chemnitz, Darmstadt, Dresden, Erlangen, Freiburg, Pfinztal, Saarbrücken, Stuttgart Energy providers e.g. Enso Dresden, Ewe, NBB, Enro, enviM Society for Heavy Ion Research Society for the Promotion of Applied Informatics Hospitals/Clinics e.g. in Bad Salzungen, Bamberg, Coburg, Cottbus, Deggendorf, Dresden, Frankfurt/Oder, Lahr, Leipzig, Ludwigsfelde, Munich, Quedlinburg, Rathenow, Regensburg, Suhl and Wiesbaden State Bureaus of Criminal Investigation e.g. in Düsseldorf, Hamburg, Mainz, Stuttgart State Police Headquarters e.g. in Chemnitz, Freiburg, Stuttgart, Munich Max Planck Institutes e.g. in Frankfurt, Garching, Golem, Heidelberg and Jena Police headquarters e.g. in Augsburg, Bayreuth, Berlin, Frankfurt, Leipzig, Munich and Nuremberg Juvenile correction facility Landshut Regulatory Agency for Telecommunications Public broadcasting agencies e.g. Bayerischer Rundfunk, Deutsche Welle and Westdeutscher Rundfunk State building surveyors' agencies e.g. in Ansbach, Ingolstadt and Nuremberg Public utility companies e.g. in Augsburg, Gießen, Heppenheim, Hürth, Kiel, Lindau, Magdeburg, Schwäbisch Gmünd and Würzburg TÜV Product Service Transfer Center for Microelectronics University clinics e.g. in Dresden, Freiburg, Gießen, Heidelberg, Tübingen and Würzburg VDE Testing and Certification Institute Waterway and Shipping Offices e.g. in Niederfinow, Nuremberg and Wilhelmshaven Municipal transit agencies e.g. in Berlin, Esslingen, Hannover, Mainz and Magdeburg **Educational and cooperative training institutes** e.g. in Eisenach, Gera and Mannheim Vocational training institutes e.g. in Berlin, Mühlenbeck and Schönbürg Institutes for ongoing vocational training e.g. in Hamburg and Tonna Trade associations e.g. in Cologne and Mannheim Professional/commercial education schools e.g. in Aalen, Aschau, Bad Kreuznach, Bayreuth, Celle, Deggendorf, Detmold, Eckernförde, Emmendingen, Esslingen, Eutin, Frankfurt, Freising, Göppingen, Hamburg, Heidenheim, Illmenau, Kempen, Cologne, Leonberg, Lübbenau, Lübeck, Oberursel, Osterode, Munich, Ravensburg, Roth, Schwäbisch Gmünd, Traunstein, Wertheim and Wuppertal Technical secondary schools e.g. in Deggendorf and Erlangen Chambers of Trades e.g. in Aachen, Kaiserslautern, Koblenz, Lübeck, Regensburg and Schwerin Heinz Nixdorf Vocational College of Essen Colleges e.g. in Amberg/Weiden, Ansbach, Berlin, Brandenburg, Biberach, Elmshorn, Emden, Esslingen, Flensburg, Heide, Heilbronn, Ingolstadt, Karlsruhe, Kiel, Cologne, Künzelsau, Landshut, Lausitz, Lübeck, Mannheim, Mittweida, Munich, Nordhausen, Regensburg, Stralsund, Ulm, Wiesbaden, Wolfenbüttel and Würzburg Technical colleges e.g. in Aachen, Leipzig, Saarbrücken and Wismar Technical universities e.g. in Berlin, Chemnitz, Clausthal-Zellerfeld, Darmstadt, Dresden, Illmenau and Munich Universities e.g. in Augsburg, Bremen, Dortmund, Erlangen, Freiburg, Frankfurt, Gießen, Göttingen, Halle, Hamburg, Heidelberg, Karlsruhe, Kassel, Magdeburg, Mainz, Mannheim, Rostock, Stuttgart, Trier, Tübingen and Zwickau **Worldwide** ABB, India Aggreko, Netherlands AKG Acoustics GmbH, Austria; Alcatel, France; Airbus, China; Airbus, Dubai; Training Center Braunau, Austria; AWECO, Slovakia; Professional Training Institute Deutschlandsberg, Austria; Bombardier Transportation Österreich GmbH, Austria; Bosch, India Bosch, Hungary; Bosch and Siemens Hausgeräte, China; Bosch and Siemens Hausgeräte, Russia; Bosch and Siemens Hausgeräte, Spain; Bosch and Siemens Hausgeräte, Turkey; Danfoss, Denmark DAIKIN, Belgium; Elbit Systems, Israel; Electrolux, Italy; ETO Magnetic, Poland; Venice Firefighting Directorate, Italy; Bolzano Trades School, Italy; INAIL Centro Protesi, Italy; Indra, Spain; Infineon Technologies Austria GmbH, Austria; Higher Technical Training Institute Mistelbach, Austria; KeyMed, Great Britain; MAF, France; Magneti Marelli Powertrain, Italy; Niko, Belgium; Lower Austrian State Firefighting Directorate, Austria; Austrian Federal Railways/Austrian Federal Army; Olympus, Czech Republic; Philips Innovative Applications, Belgium; Robert Bosch AG, Austria; Sagem, France Schaeffler, China; Schaeffler, Romania Schaeffler, USA; Siemens, China; Società delle Autostrade di Venezia e Padova S.p.a., Italy; St. Microelectronics S.p.a., Italy; Suez, Belgium; Tessenderlo Chemie, Belgium; Thales, France

2005

2003
Modular assembly workstations.

2005
ELABO creates a sensation with its fully re-developed C# software bundle. For the first time, it is possible to perfectly coordinate object-oriented software modules.

2010

2010
Elution®: Total integration of testing technology and measurement electronics in the ELABO software world.

2009
ELABO's HighPerformance device series ushers in a new era of modular devices for safety testing equipment.

2012
ELABO continues the revolution in work-station systems. Primus One® is a genuine masterpiece!

2015

2015
Inclusion in the "100 Orte BW" list and the German Ministry of Trade and Industry's digital map

2014
ELABO unveils the Smart Factory for the first time at the trade fair in Munich and subsequently installs it at the main plant in Crailsheim

2016
Revolutionising the market for workplace systems using the CIS concept

2018
Introducing new digital services to the market

"AR and VR solutions" as well as digital field service

2017
ELABO launches the guided tour.

FIM workplace for shop floor solutions is developed.



ELABO GmbH
Roßfelder Straße 56
74564 Crailsheim
Germany

Phone +49 7951 307-0
Fax +49 7951 307-66

info@elabo.de
www.elabo.com